

## First Floor

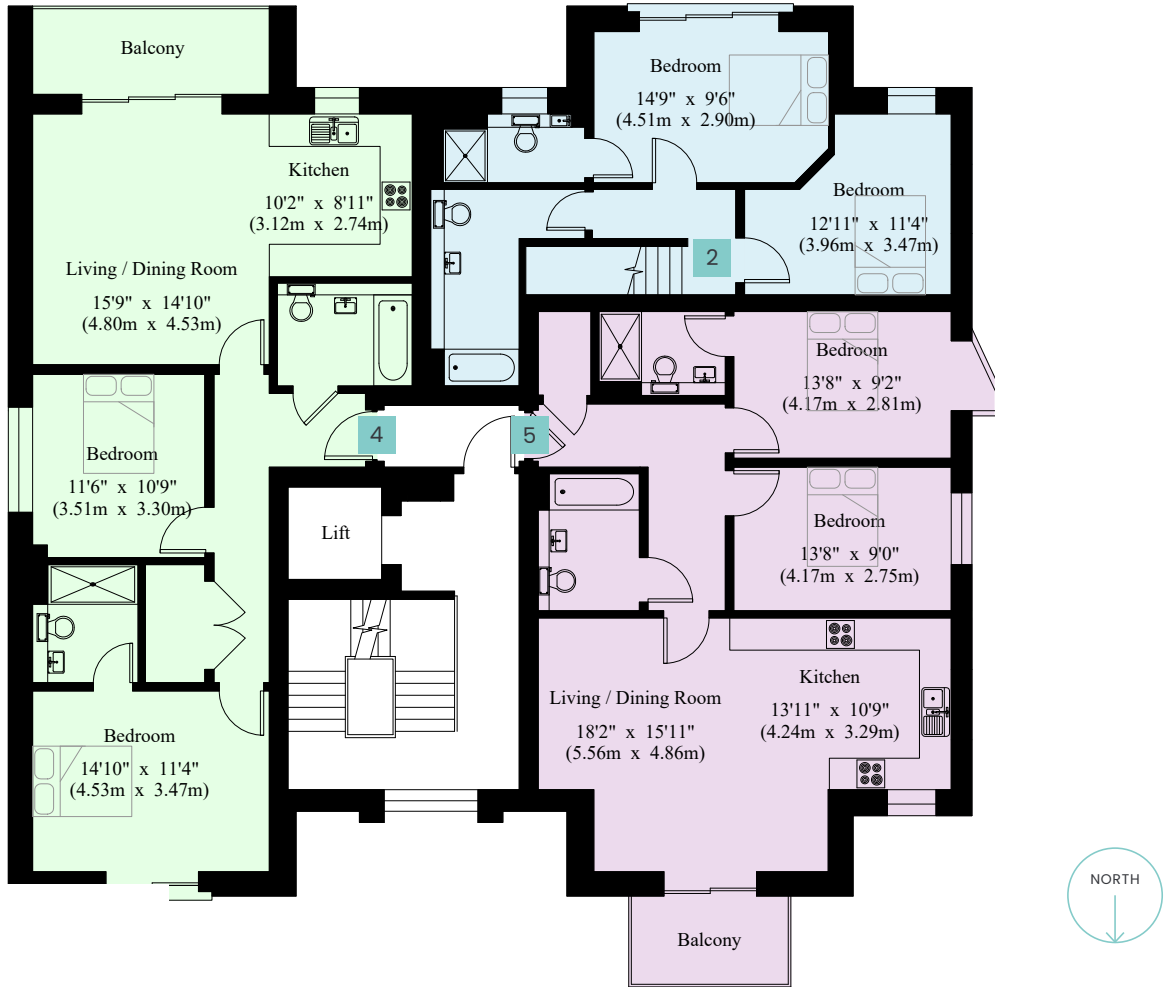

### APT 5

Kitchen	4.24m x 3.29m	13'11" x 10'9"
Living / Dining Room	5.56m x 4.86m	18'2" x 15'11"
Master Bedroom	4.17m x 2.81m	13'8" x 9'2"
Bedroom 2	4.17m x 2.75m	13'8" x 9'0"
<b>Total</b>	<b>79.25 sq m</b>	<b>853 sq ft</b>